

Part number TG022000 Model: GEAR BOX S3/D 2M

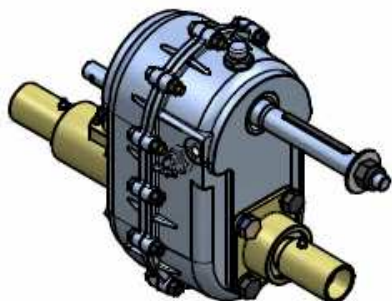

Expressly developed and manufactured for engine up to 50 HP, the gear box 22000, made in small dimensions, allows easy installation and assembly operations. The gear units are carried out with helical lapped toothing, in order to reduce the noise level, as well the use of special steel hardening material warrants the metal fatigue heavy duty and the transmittable power reliability. The use of bearings, with one ball ring on the speed and middle ranking shafts and adjustable conic roller bearings on the low differential shaft, reduces considerably the energy level; in the meanwhile the employment of bearings, with two ball rings on the engine shaft, cuts out the inconveniences of the radial strains due to the engine or variable speed driver position, normally not in axletree. The clutch pins made with dovetail provide a safety grip, so avoiding the accidental gears disconnection in case of vibrations, vehicle jolts, etc.

Application fields: Mini cars, agricultural devices, three-wheelers, golf cars, amusement vehicles, motor-sleigh, industry, etc.

Fulfilment: differential gear box with two forward and one reverse speeds. Helical lapped toothing gears, bearings Ø 52 mm, double ball rings on the engine shaft, adjustable conic roller bearings on the low differential shaft.

Drive gear ratios: From 2:1 to 10:1.

Gears: two forward speeds, one reverse speed and two neutral positions.

Out-put maximum torque: 1.000 Nm.

Differential out-put maximum torque: 1.000 Nm (500 Nm at any semi axel).

Lubrication oil quantity: 0,850 Kg.

Accessories: Intake for odometer with different ratios compare the wheel diameter, remote control with gear selector.

STANDARD DRIVE GEARS: 3,5:1 (L) – 6:1(H) or 4,96:1 (L) – 2,89:1 (H)

THE OUT-PUT AND ENGINE SHAFTS CAN BE DRAWN IN DIFFERENT SHAPE AND DIMENSIONS AT SPECIAL CUSTOMER REQUEST.

WEIGHT WITHOUT ANY ACCESSORY UNITS: 14 Kg.

Desmodromico gear system with or without differential group, with or without block device.